

### GENERAL SPECIFICATION

**LED:** High efficiency mid-power LEDs are field serviceable. Universal voltage.

**Acrylic:** Satin white acrylic is UL-94 HB Flame Class rated.

**Finish:** Highly durable oven cured no VOC premium powder coat. Fixture painted textured white.

**Dimming:** 0-10V dimming standard.

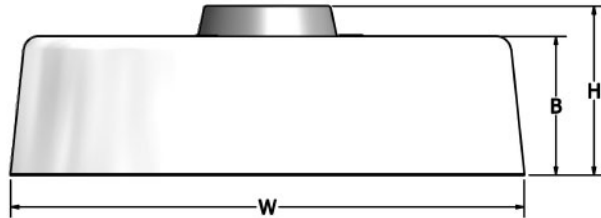

SAMPLE CATALOG NUMBER: GL-3635-				A-	A-
MODEL NO.				LAMPING	OPTIONS
GL-3635	W in 26"	mm 660		A. 5LED30	A. No Options EL. Emergency LED Remote mount up to 10' from lamping in controlled environment with an area temperature range of 32°-131°F. Specify 120 or 277 voltage.
	8lbs B in 8"	mm 205		B. 5LED35	
	3.5kg H in 8 3/8"	mm 215		C. 5LED40	
Fixture Painted White					
GL-3636	W in 37 1/2"	mm 950		D. 8LED30	
	10lbs B in 8"	mm 205		E. 8LED35	
	4.5kg H in 8 3/8"	mm 215		F. 8LED40	
Fixture Painted White					

All Dimensions are nominal.

### Lamp Code Definition

Code	Total Wattage	CRI	Rated Life Hrs	Delivered Lumens	Kelvin
5LED30	72	+80	50000	7047	3000
5LED35	72	+80	50000	7047	3500
5LED40	72	+80	50000	7047	4000
8LED30	113	+80	50000	11802	3000
8LED35	113	+80	50000	11802	3500
8LED40	113	+80	50000	11802	4000